

Glenwood St. - Church of Christ Subdivision

D.R. 135 Page 613

August 6, 1948

Scale: 1" = 100'

Out of "School Tract" as shown on Plat of SUBER'S 5TH ADDITION (D.R. 51, Pg. 422, 16-7-36)

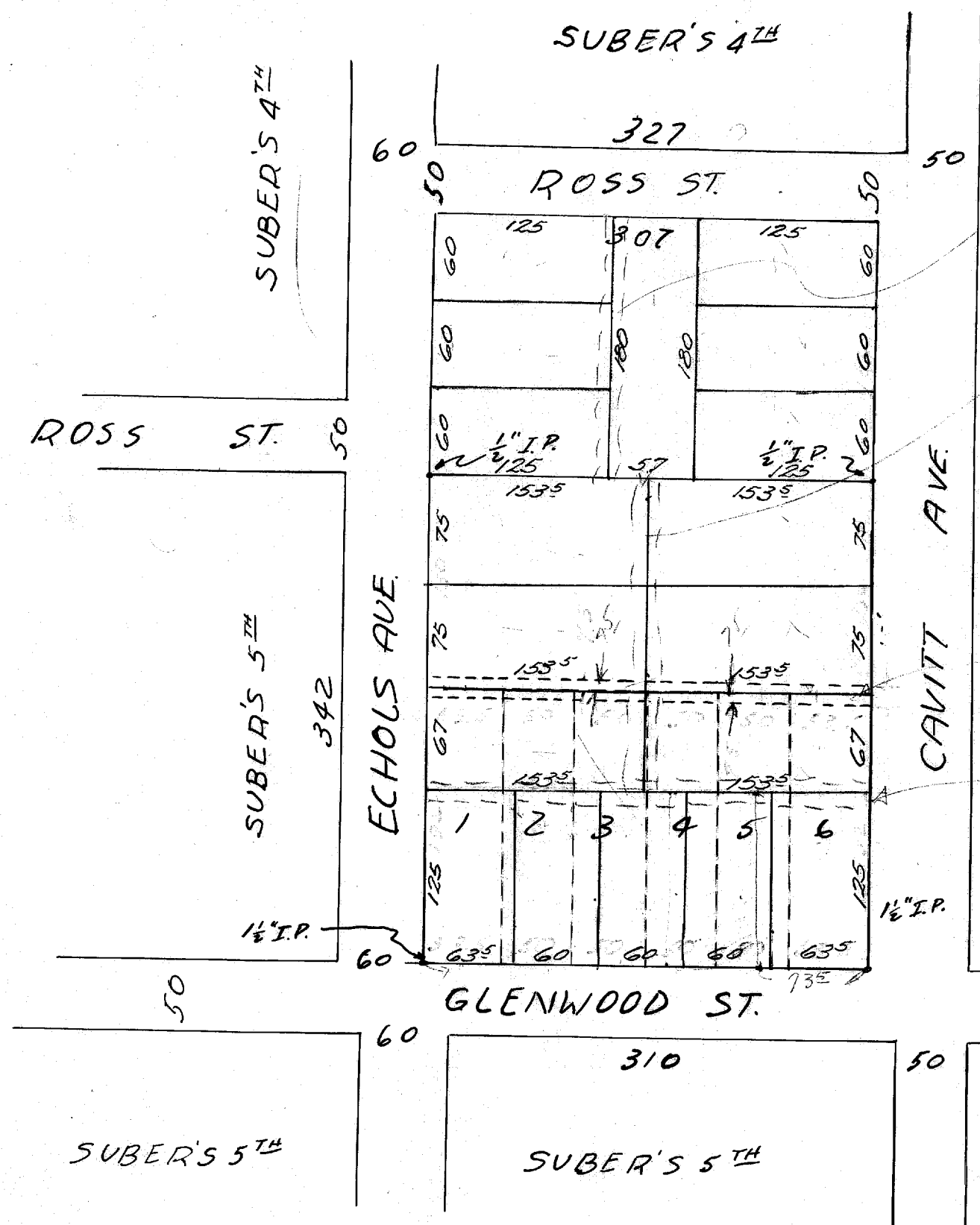

10' easement D/R 162

(15' easement) D/R 160/397

WATSON ADDN.

this easement on Recorded Plat (15')

D/R 160/396 (10')

outstanding on plat